

FLAT CONDITION

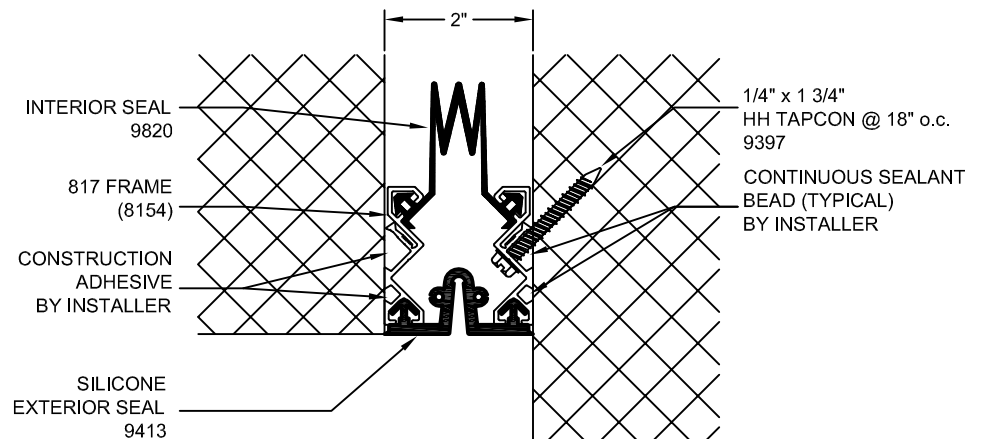

CORNER CONDITION

**VSS-200-SIL-E**

**FASTENING NOTE:**

SYSTEM SUPPLIED WITH ANCHORS AS SHOWN. INSTALLER TO DETERMINE IF SUPPLIED ANCHORS ARE APPROPRIATE FOR SUBSTRATE, IF NOT, ANCHORS ARE TO BE SUPPLIED BY OTHERS. FRAMES MAY BE INSTALLED USING A STRUCTURAL ADHESIVE (BY OTHERS) APPROVED BY THE ARCHITECT AND IN ACCORDANCE WITH THE SEALANT MANUFACTURERS RECOMMENDATIONS. MM SYSTEMS CORPORATION RECOMMENDS THAT THE FRAMES BE MECHANICALLY FASTENED AT THE TOP, CENTER AND BOTTOM OF EACH FRAME SECTION.  
 \*\*\* ALLOW A 1/4" CAULK JOINT BETWEEN EACH 20'-0" FRAME SECTION.

**ARCHITECT/CONTRACTOR NOTE:**

ALL SUBASSEMBLY COMPONENTS TO BE PROVIDED IN 10'-0" OR 20'-0" STOCK LENGTHS UNLESS OTHERWISE NOTED. THE SPECIFIC SYSTEMS DICTATE THE LENGTHS PROVIDED.

Approved by: \_\_\_\_\_ Date: \_\_\_\_\_

**SEAL NOTE: SPECIFY SEAL COLOR**

STANDARD COLORS:

- CARBON (BLACK)       PRAIRIE (BEIGE)
- FOG (GRAY)             LUNAR (WHITE)

\*CUSTOM COLOR AVAILABLE IN MINIMUM QUANTITIES 100 LF. CONTACT MM FOR PRICING & AVAILABILITY.

Representative:	Customer:	Project:	Location:	Project Number:
-----------------	-----------	----------	-----------	-----------------



**MM SYSTEMS**  
 50 MM WAY  
 PENDERGRASS, GA. 30567  
 PHONE: 706-824-7500  
 866-50 MM WAY  
 866-506-6929  
 FAX: 706-824-7501  
[www.mmsystemscorp.com](http://www.mmsystemscorp.com)

For Spec-Data, Installation Guides, or movement requirements, contact MMSC

**RIGHTS OF DESIGN**

All rights of design, detail, engineering and/or invention contained herein are the property of MM Systems Corporation and hereby reserved and are not to be reproduced or provided to any other party. MM Systems Corporation reserves the right to amend or withdraw any information contained herein without notice and will not be liable for any inaccuracy or ambiguity of said information.

VSS-200-SIL-E

Model:		Drawing Number:	
Drawn by:	Scale:	Issue Date:	
.	NTS	03-17-11	
SHT. . OF .			